

GORDON®
ARCHITECTURAL+ENGINEERED SOLUTIONS

5023 Hazel Jones Rd.
Bossier City, LA 71111
800.747.8954
GORDON-INC.COM
sales@gordon-inc.com

**SECURITY CEILINGS
TAMPER-PROOF - CEL-LINE - EXPOSED
ISOMETRIC ASSEMBLY**

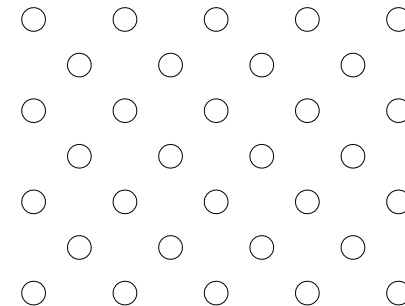
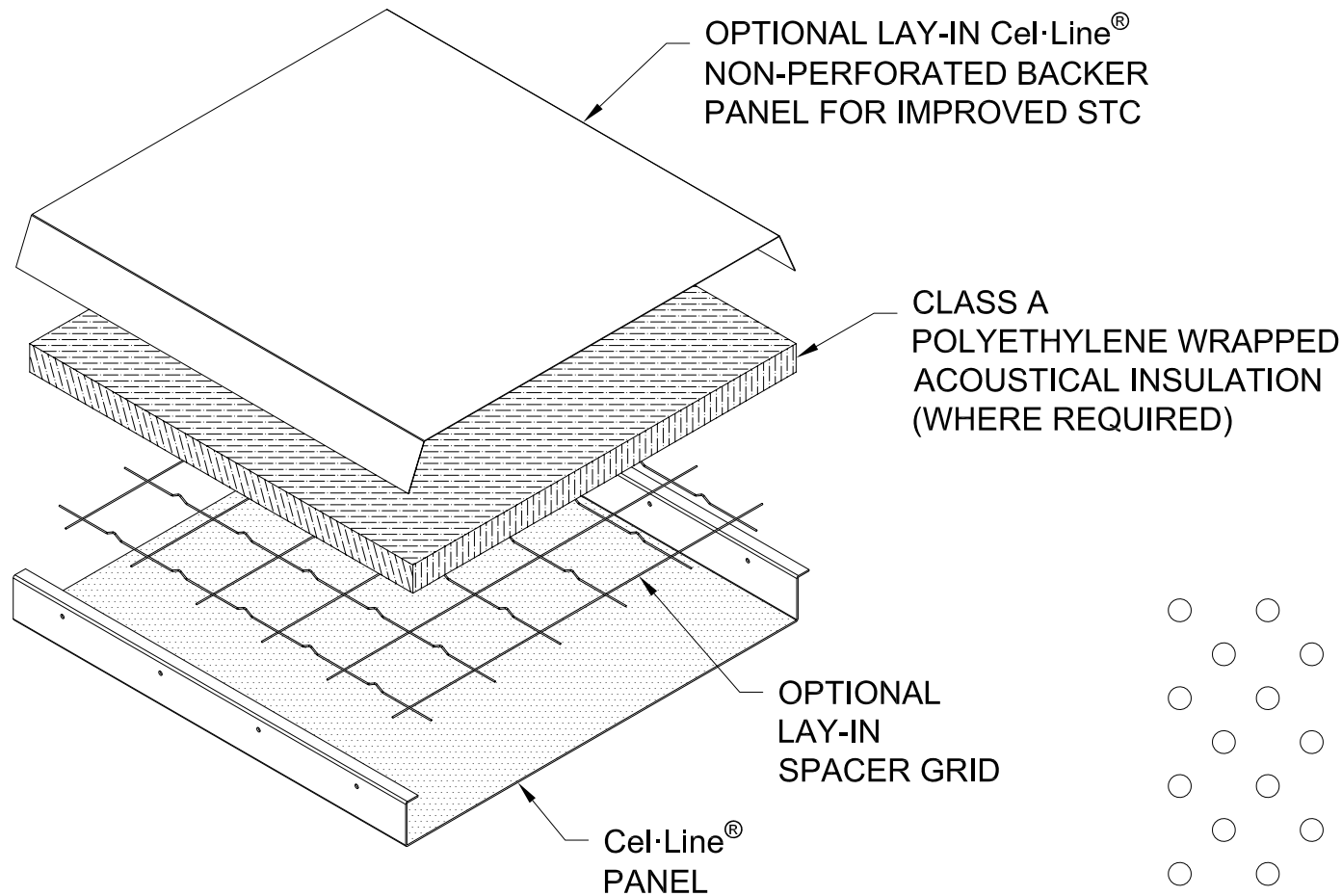

R18-1132DG11 PANEL PERFORATION DETAIL
1/8" HOLES ON 1 1/32" 45° DIAGONAL CENTERS
11% OPEN AREA

SELF-DRILLING
STITCHING FASTENER
3" MAX FROM END OF PANEL
AND 12" ON CENTER MAX

CLASS A
POLYETHYLENE WRAPPED
ACOUSTICAL INSULATION
(WHERE REQUIRED)

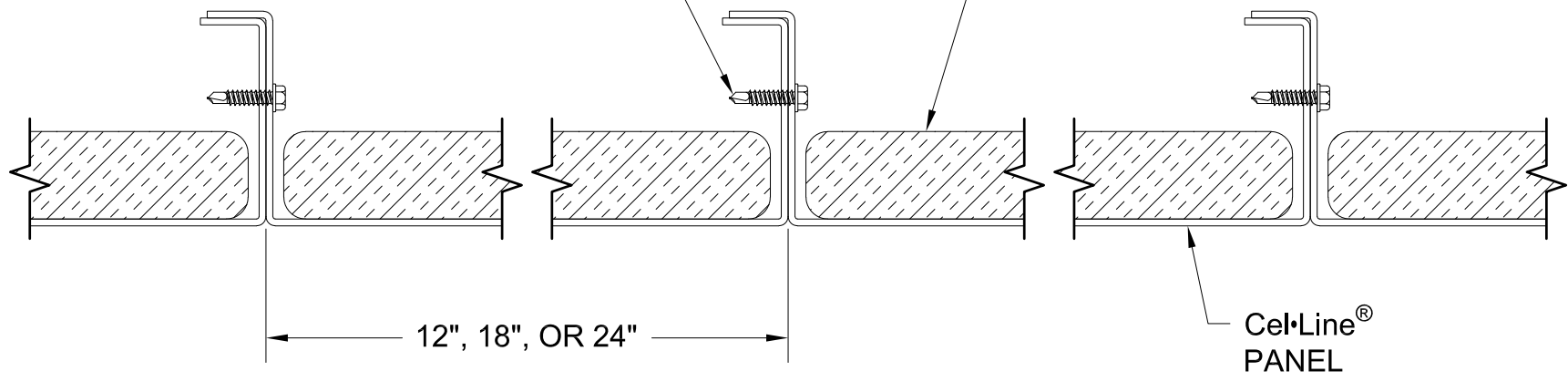

GORDON®
ARCHITECTURAL+ENGINEERED SOLUTIONS

5023 Hazel Jones Rd.
Bossier City, LA 71111
800.747.8954
GORDON-INC.COM
sales@gordon-inc.com

SECURITY CEILINGS
TAMPER-PROOF – CEL-LINE - EXPOSED
TYPICAL PANEL SECTION

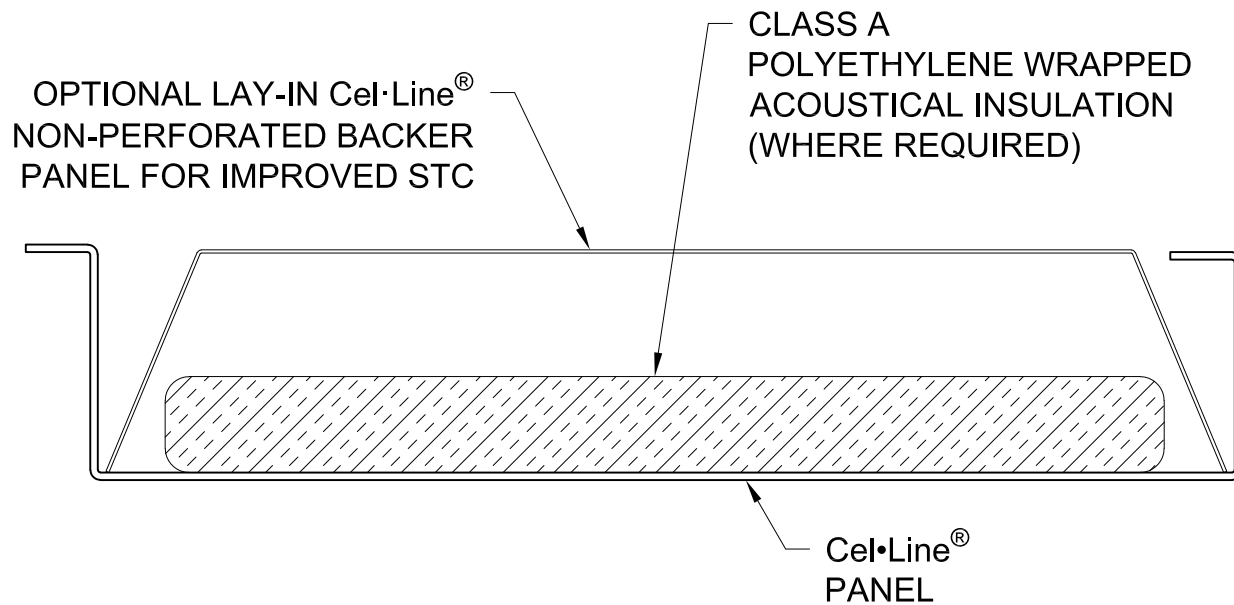

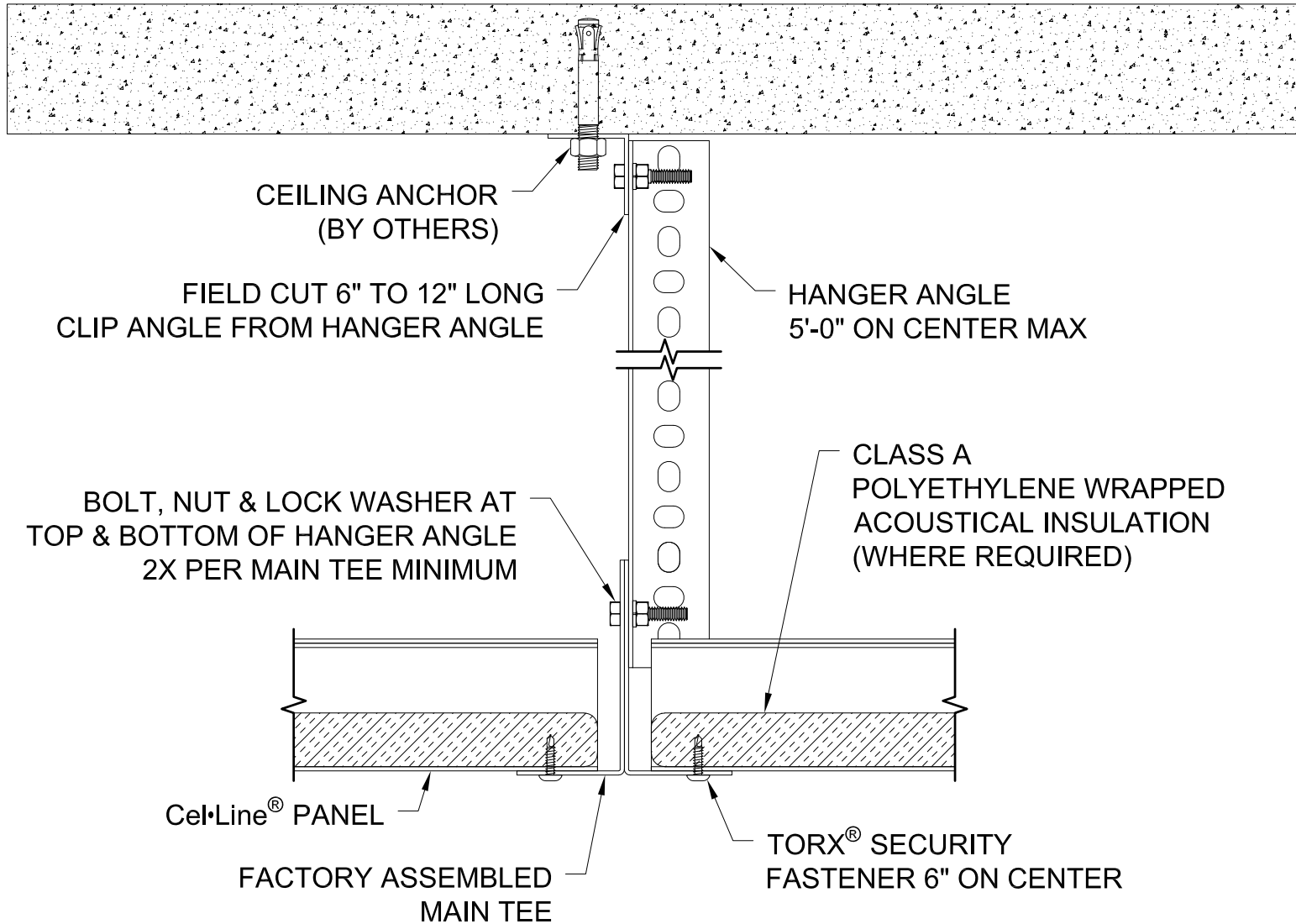

TORX® IS A REGISTERED
TRADEMARK OF CAMCAR

GORDON®
ARCHITECTURAL+ENGINEERED SOLUTIONS

5023 Hazel Jones Rd.
Bossier City, LA 71111
800.747.8954
GORDON-INC.COM
sales@gordon-inc.com

SECURITY CEILINGS
TAMPER-PROOF – CEL-LINE - EXPOSED
MAIN TEE SECTION

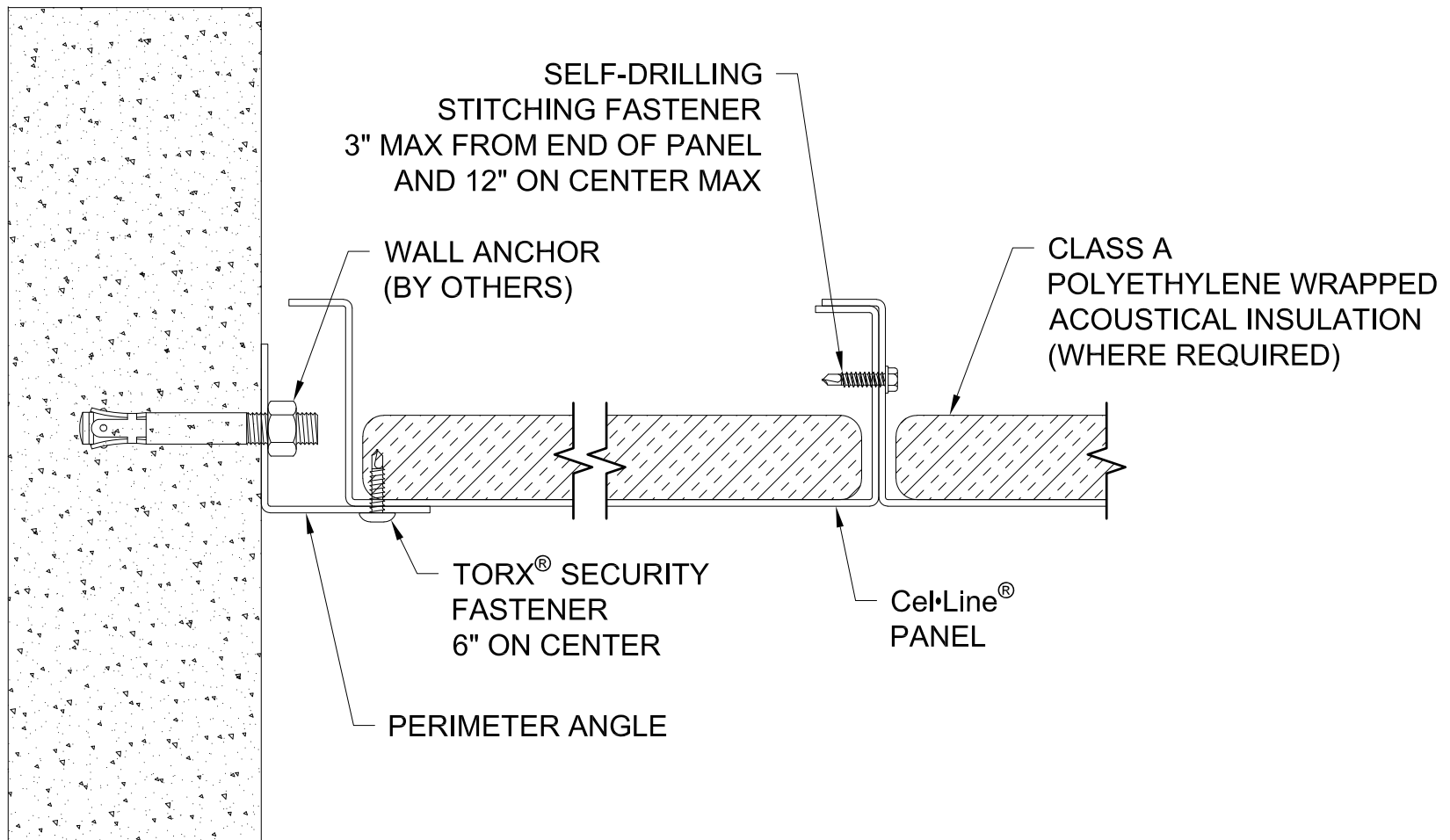

TORX® IS A REGISTERED
TRADEMARK OF CAMCAR

GORDON®
ARCHITECTURAL+ENGINEERED SOLUTIONS

5023 Hazel Jones Rd.
Bossier City, LA 71111
800.747.8954
GORDON-INC.COM
sales@gordon-inc.com

SECURITY CEILINGS
TAMPER-PROOF – CEL-LINE - EXPOSED
START PANEL SECTION

CLASS A
POLYETHYLENE WRAPPED
ACOUSTICAL INSULATION
(WHERE REQUIRED)

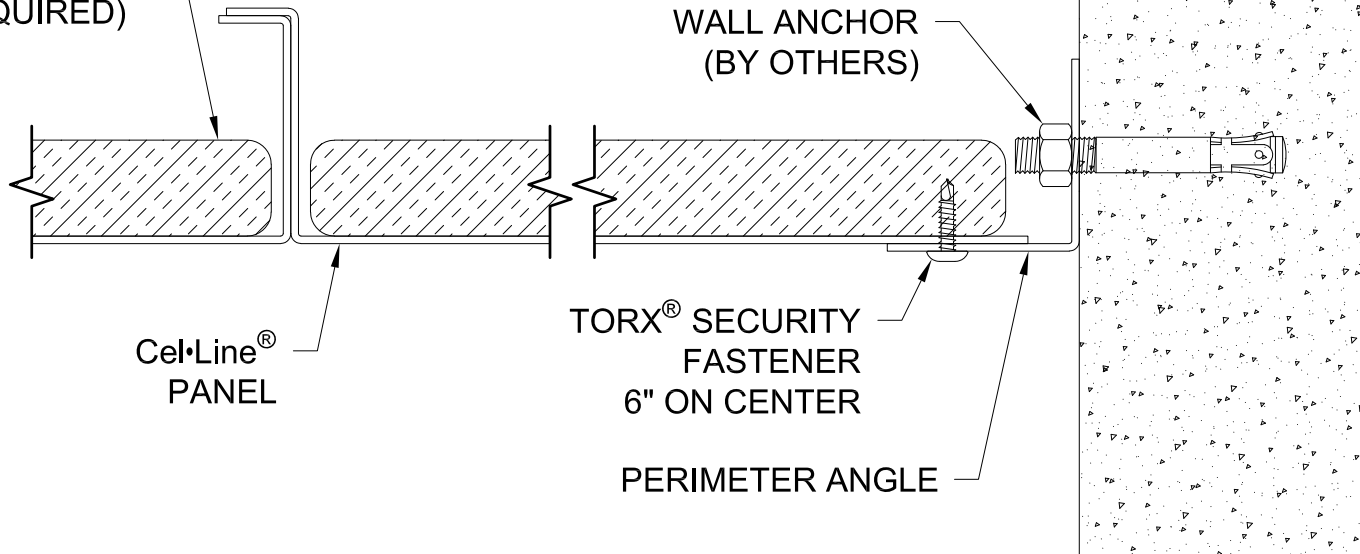

TORX® IS A REGISTERED
TRADEMARK OF CAMCAR

GORDON®
ARCHITECTURAL+ENGINEERED SOLUTIONS

5023 Hazel Jones Rd.
Bossier City, LA 71111
800.747.8954
GORDON-INC.COM
sales@gordon-inc.com

SECURITY CEILINGS
TAMPER-PROOF – CEL-LINE - EXPOSED
LAST PANEL SECTION

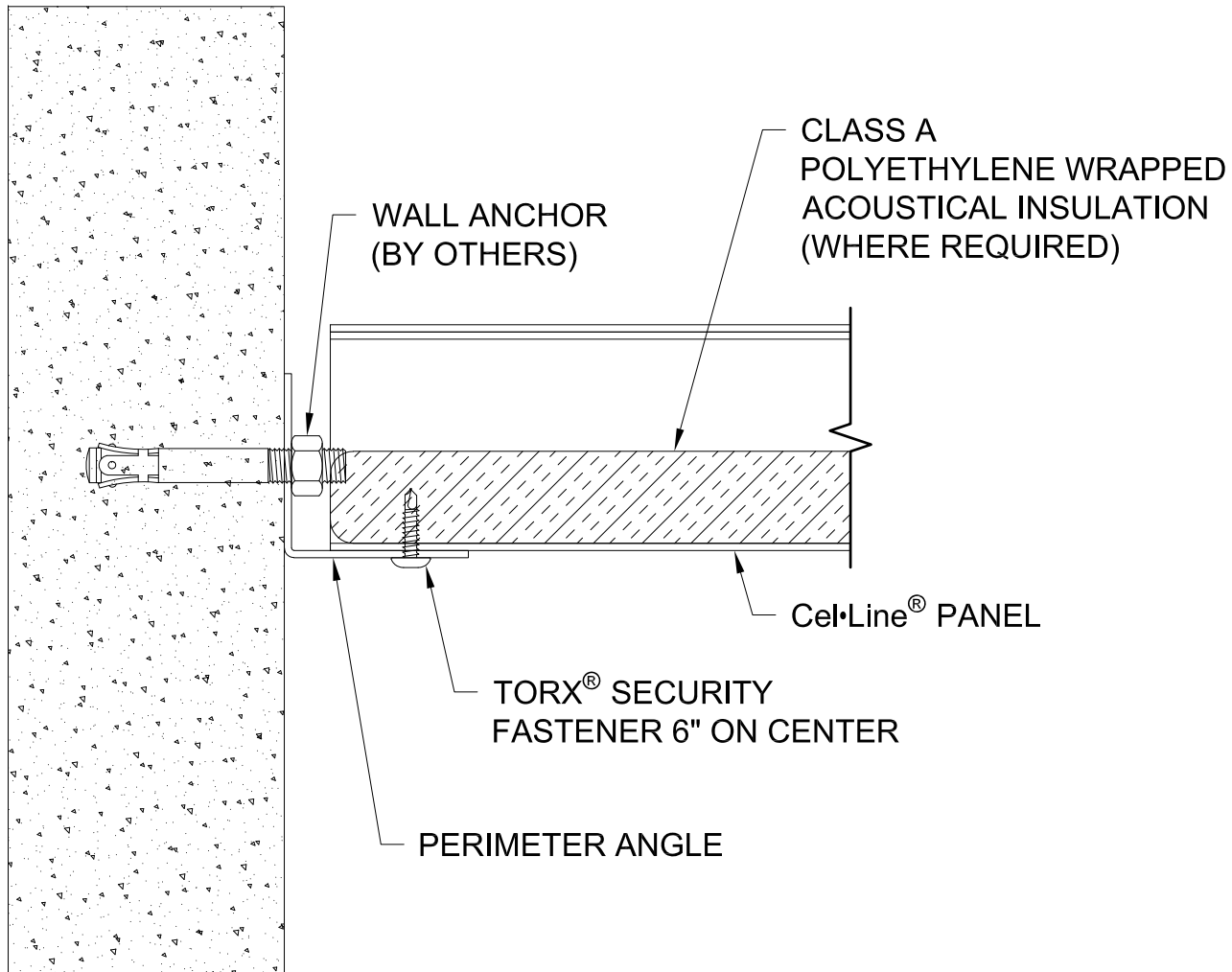

TORX® IS A REGISTERED
 TRADEMARK OF CAMCAR

GORDON®
 ARCHITECTURAL+ENGINEERED SOLUTIONS

5023 Hazel Jones Rd.
 Bossier City, LA 71111
 800.747.8954
 GORDON-INC.COM
 sales@gordon-inc.com

SECURITY CEILINGS
 TAMPER-PROOF - CEL-LINE - EXPOSED
 END OF PANEL SECTION

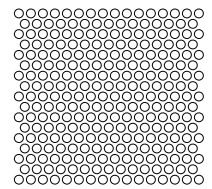
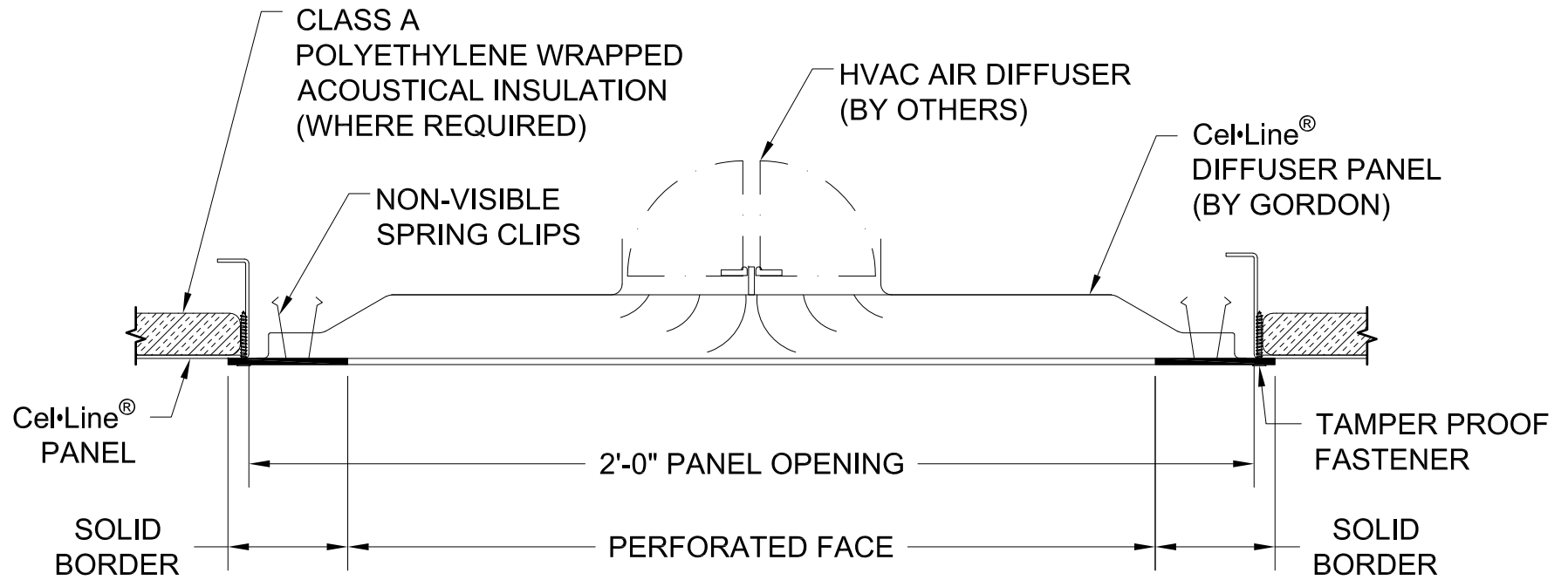

DIFFUSER PANEL PERFORATION PATTERN
3/16" HOLES ON 1/4" STAGGERED CENTERS
50% OPEN AREA

OTHER PERFORATION PATTERNS ARE AVAILABLE
 (CONTACT FACTORY)

GORDON® ARCHITECTURAL+ENGINEERED SOLUTIONS
 5023 Hazel Jones Rd.
 Bossier City, LA 71111
 800.747.8954
 GORDON-INC.COM
 sales@gordon-inc.com

SECURITY CEILINGS
 TAMPER-PROOF – CEL-LINE - EXPOSED
 HVAC DIFFUSER SECTION

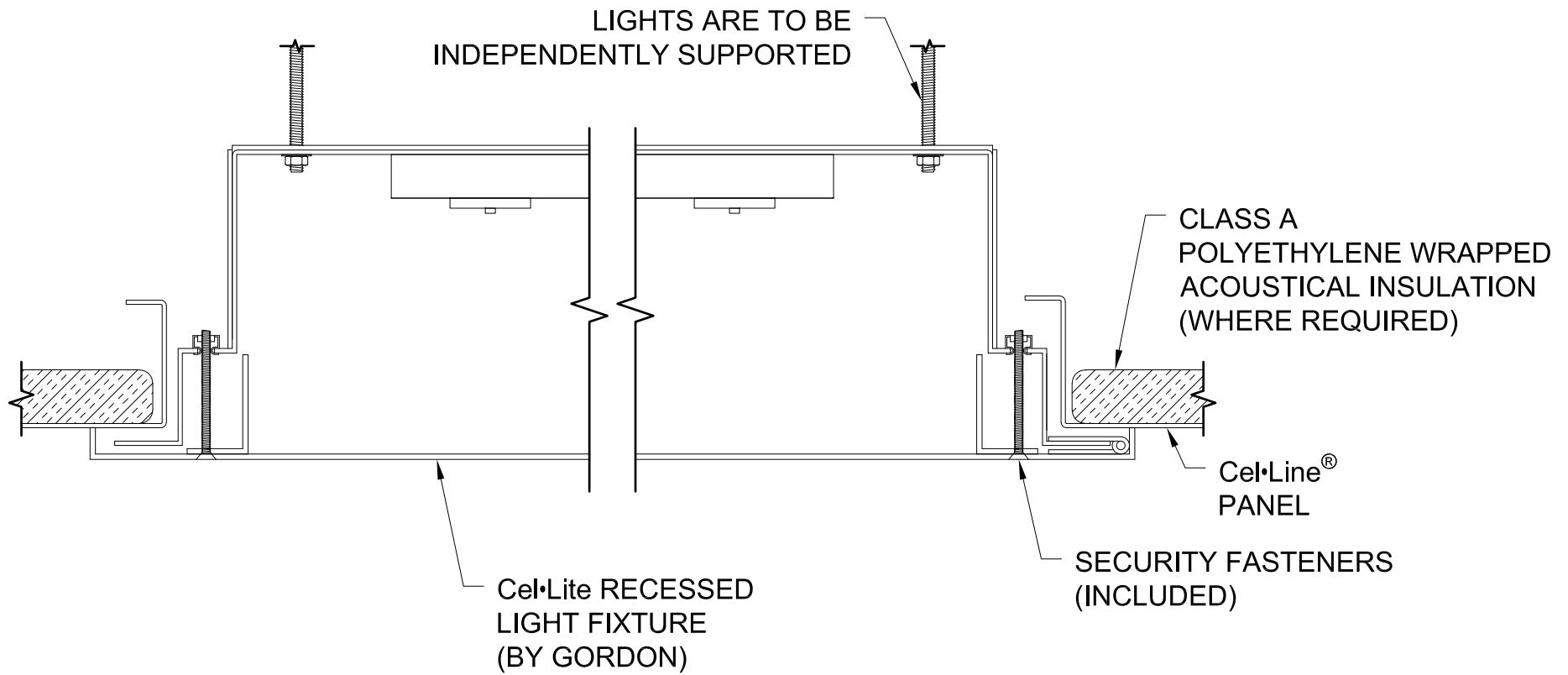

GORDON®
ARCHITECTURAL+ENGINEERED SOLUTIONS

5023 Hazel Jones Rd.
Bossier City, LA 71111
800.747.8954
GORDON-INC.COM
sales@gordon-inc.com

SECURITY CEILINGS
TAMPER-PROOF – CEL-LINE - EXPOSED
RECESSED LIGHT SECTION

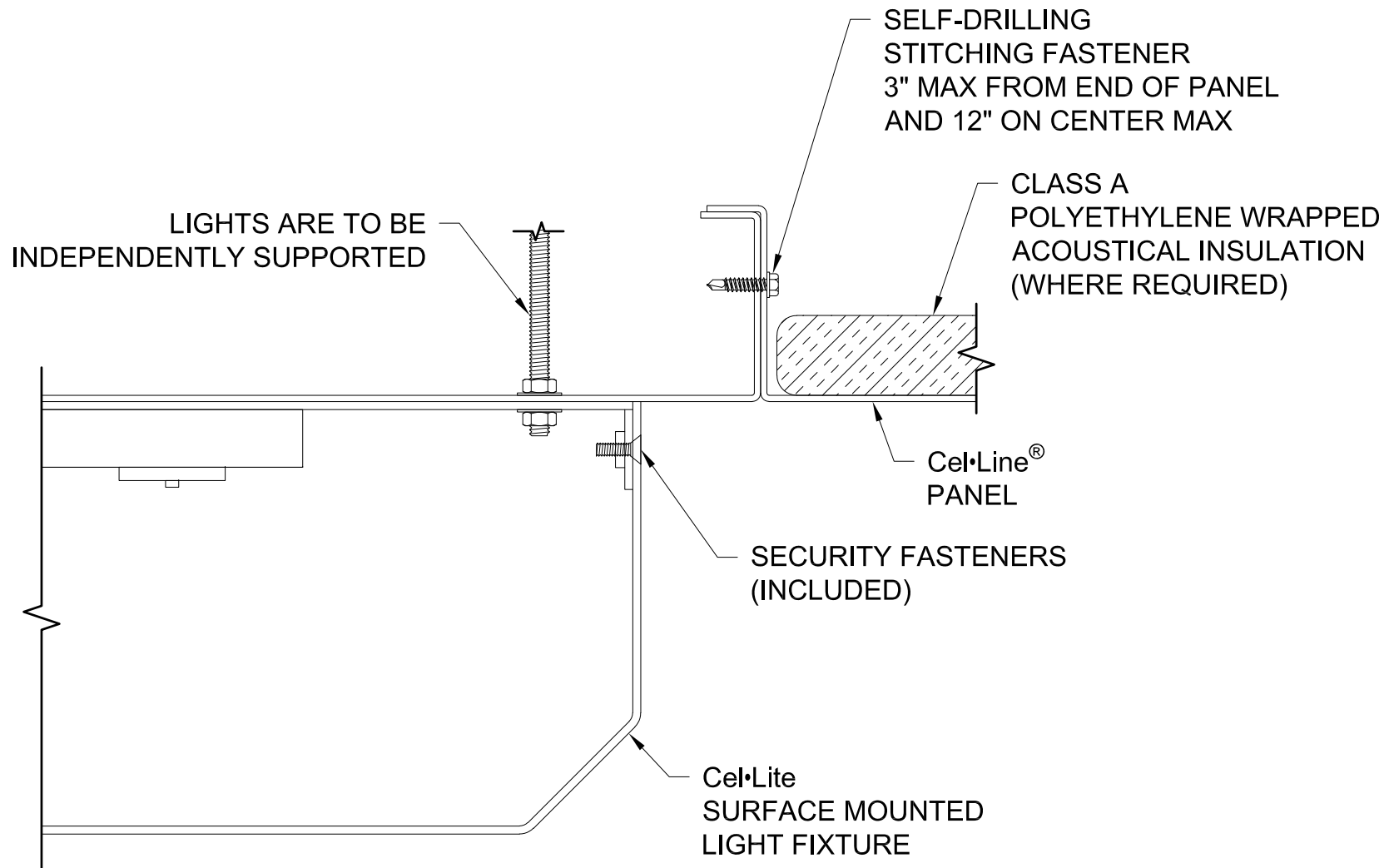

GORDON®
ARCHITECTURAL+ENGINEERED SOLUTIONS

5023 Hazel Jones Rd.
Bossier City, LA 71111
800.747.8954
GORDON-INC.COM
sales@gordon-inc.com

SECURITY CEILINGS
TAMPER-PROOF - CEL-LINE - EXPOSED
SURFACE LIGHT SECTION

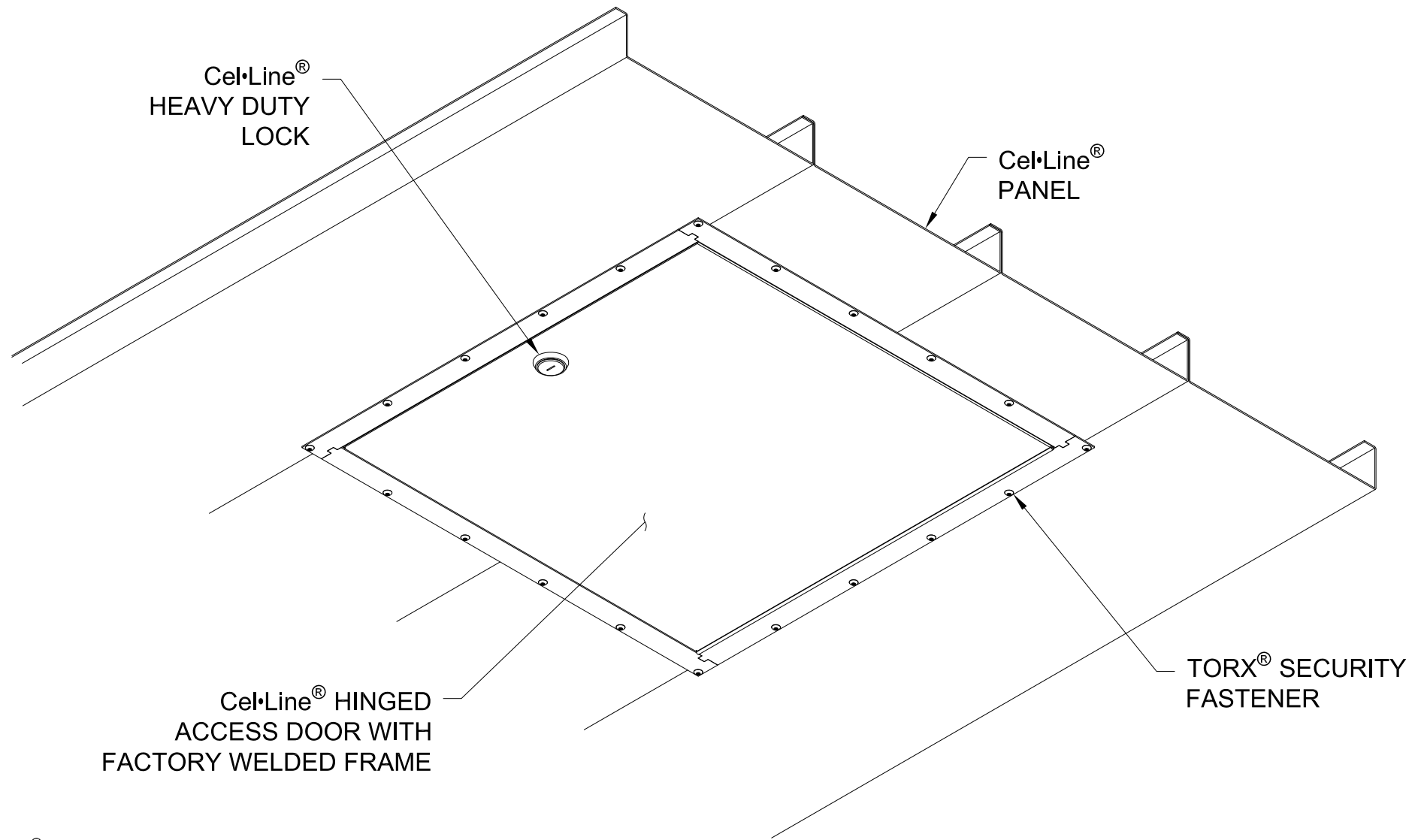

TORX® IS A REGISTERED
TRADEMARK OF CAMCAR

STANDARD SIZES: 2' X 2' AND 2' X 4'
(OTHER SIZES AVAILABLE)

GORDON®
ARCHITECTURAL+ENGINEERED SOLUTIONS

5023 Hazel Jones Rd.
Bossier City, LA 71111
800.747.8954
GORDON-INC.COM
sales@gordon-inc.com

**SECURITY CEILINGS
TAMPER-PROOF - CEL-LINE - EXPOSED
ACCESS DOOR ISOMETRIC**

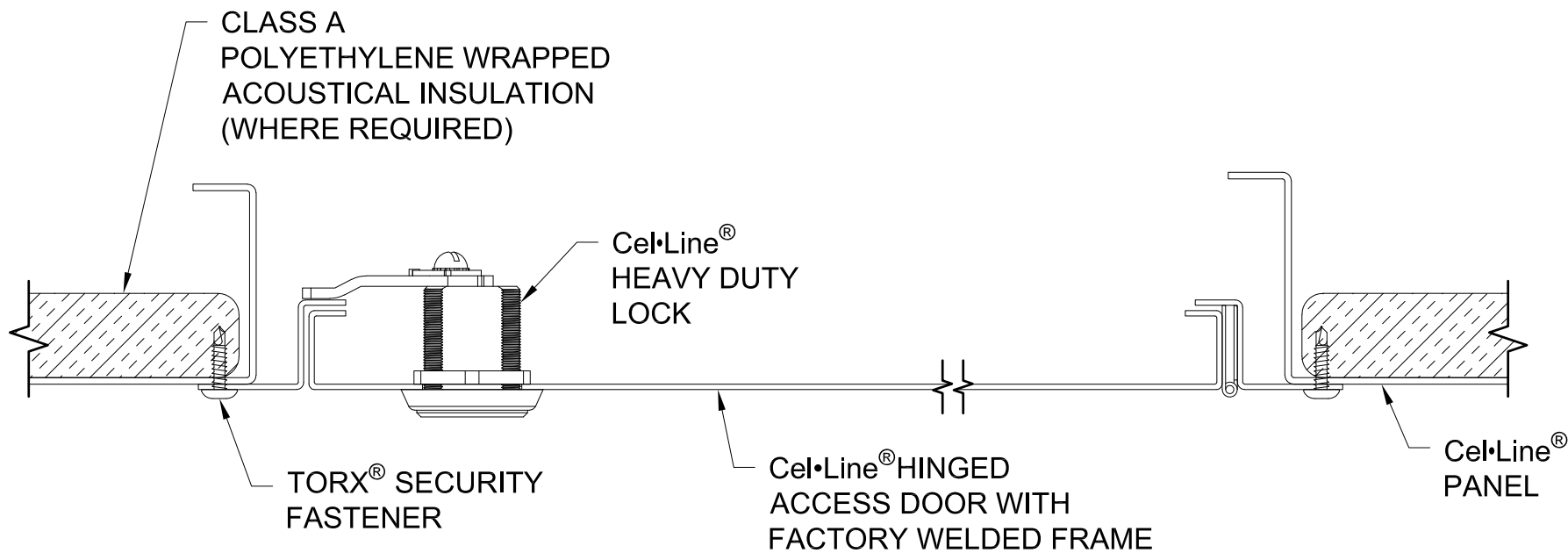

TORX® IS A REGISTERED
TRADEMARK OF CAMCAR

STANDARD SIZES: 2' X 2' AND 2' X 4'
(OTHER SIZES AVAILABLE)

GORDON®
ARCHITECTURAL+ENGINEERED SOLUTIONS

5023 Hazel Jones Rd.
Bossier City, LA 71111
800.747.8954
GORDON-INC.COM
sales@gordon-inc.com

**SECURITY CEILINGS
TAMPER-PROOF - CEL-LINE - EXPOSED
ACCESS DOOR SECTION**

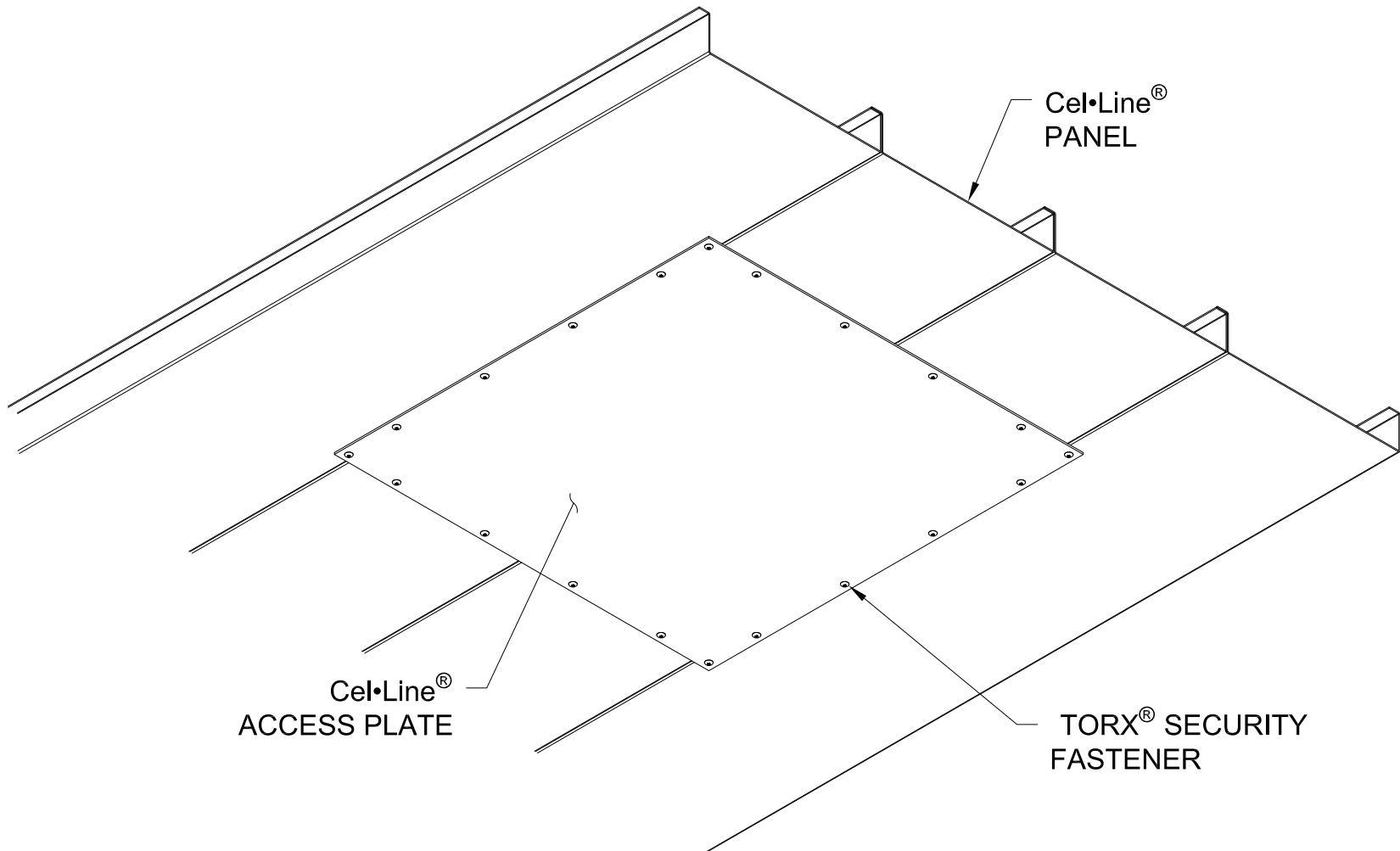

TORX® IS A REGISTERED
TRADEMARK OF CAMCAR

STANDARD SIZES AVAILABLE:
1'-6" X 1'-6", 2' X 2' AND 2' X 4'

GORDON®
ARCHITECTURAL+ENGINEERED SOLUTIONS

5023 Hazel Jones Rd.
Bossier City, LA 71111
800.747.8954
GORDON-INC.COM
sales@gordon-inc.com

SECURITY CEILINGS
TAMPER-PROOF - CEL-LINE - EXPOSED
ACCESS PLATE ISOMETRIC

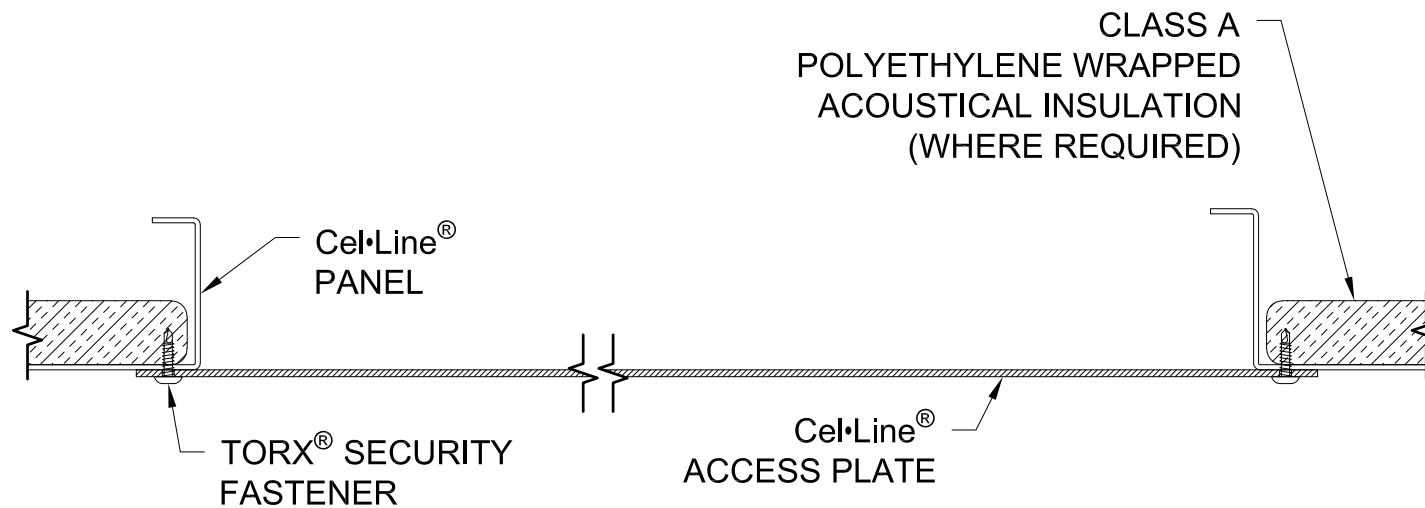

STANDARD SIZES AVAILABLE:
1'-6" X 1'-6", 2' X 2' AND 2' X 4'

GORDON®
ARCHITECTURAL+ENGINEERED SOLUTIONS

5023 Hazel Jones Rd.
Bossier City, LA 71111
800.747.8954
GORDON-INC.COM
sales@gordon-inc.com

SECURITY CEILINGS
TAMPER-PROOF - CEL-LINE - EXPOSED
ACCESS PLATE SECTION

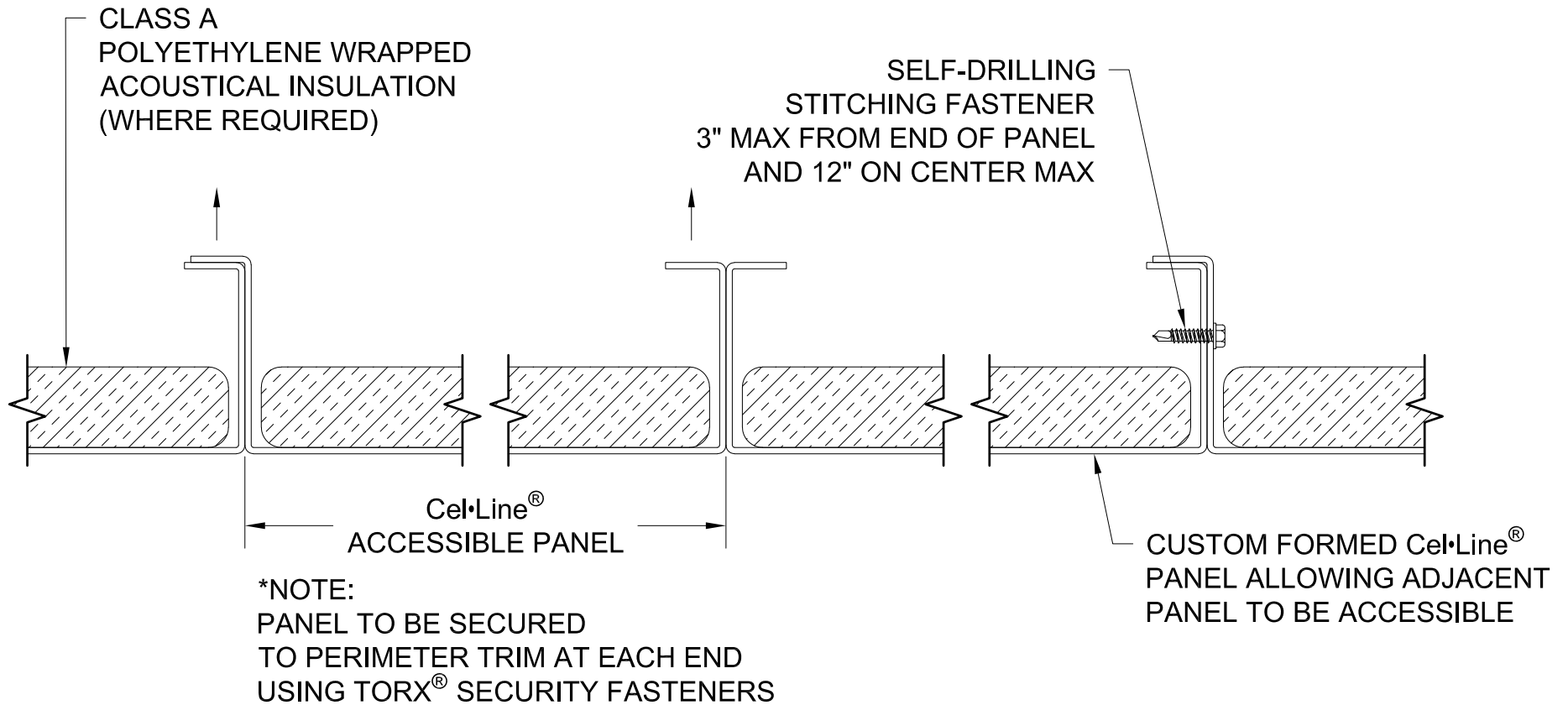

TORX® IS A REGISTERED
TRADEMARK OF CAMCAR

GORDON®
ARCHITECTURAL+ENGINEERED SOLUTIONS

5023 Hazel Jones Rd.
Bossier City, LA 71111
800.747.8954
GORDON-INC.COM
sales@gordon-inc.com

SECURITY CEILINGS
TAMPER-PROOF - CEL-LINE - EXPOSED
ACCESS PANEL SECTION