

HOOK-ON

ACCESSIBLE CEILING SYSTEMS

GORDON
INCORPORATED

- HOOK-ON metal ceilings provide a monolithic, accessible ceiling system. Heavy-duty extruded aluminum suspension is wire-hung and does not require black iron.
- Meets ASTM and CISCA specifications
- Installed flat, sloped, or segmented to simulate vault conditions
- Accessible
- Acoustical media available
- Contributes to LEED^{®1} Certification
- Panels
 - Materials: Aluminum, Steel, Stainless Steel: #4, #8, Mechanical and Textured/ Embossed
 - Perforated or Non-perforated
 - Shapes: Square, Rectangular, Triangular, and Trapezoidal
 - Sizes: Up to 4' x 10'
- System Integration
 - Air Slots
 - Lighting
 - FlexHead^{®2} Sprinklers
 - Perimeter Pockets
 - Penetrations
 - Speakers
 - Columns
 - Lights
 - Air
- Finishes
 - Powder Coated Durable Finishes
 - Standard
 - ACROGUARD[®] Enhanced Durability
 - ACROGUARD[®] Patina
 - ACROGUARD[®] Textured
 - ACROGUARD[®]-UVX Durable Exterior
 - ACROSTAT[™] Antimicrobial
 - GreenWood[™]
 - Wood Grain Films
 - Wood Grain Paints
 - Mechanical & Enhanced Finishes
- Optional Accessories
 - Contura
 - Wall Angle
 - Custom Perimeter Trims
 - Safety Cables



CISCA Construction Excellence
Award Winner

FULTON CENTER
New York, NY



CISCA Construction Excellence
Award Winner

BOSTON LOGAN INTERNATIONAL AIRPORT,
TERMINAL C, SECURITY CHECKPOINT
East Boston, MA

HOOK-ON

PRODUCT INFORMATION

GORDON
INCORPORATED

DETAILS

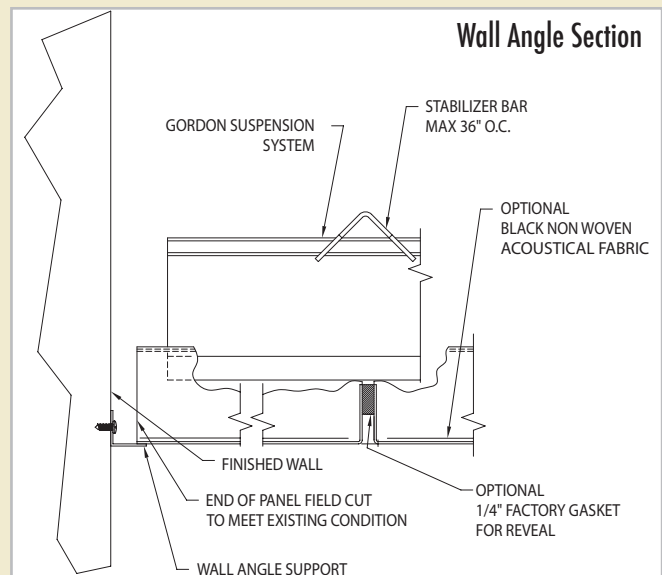
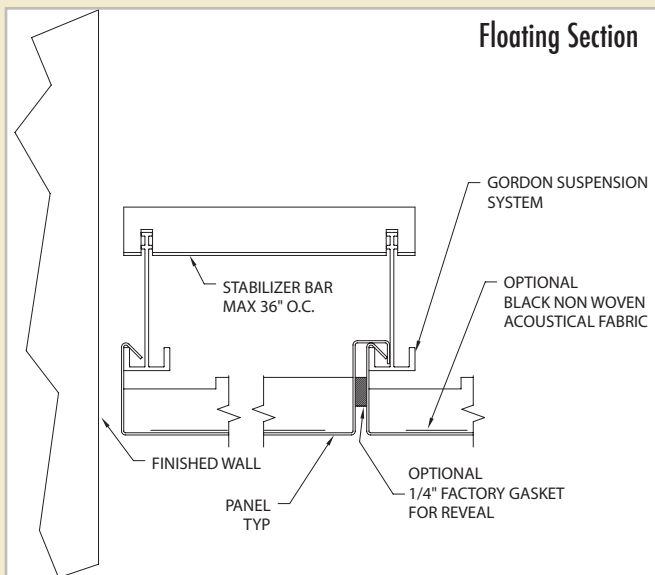
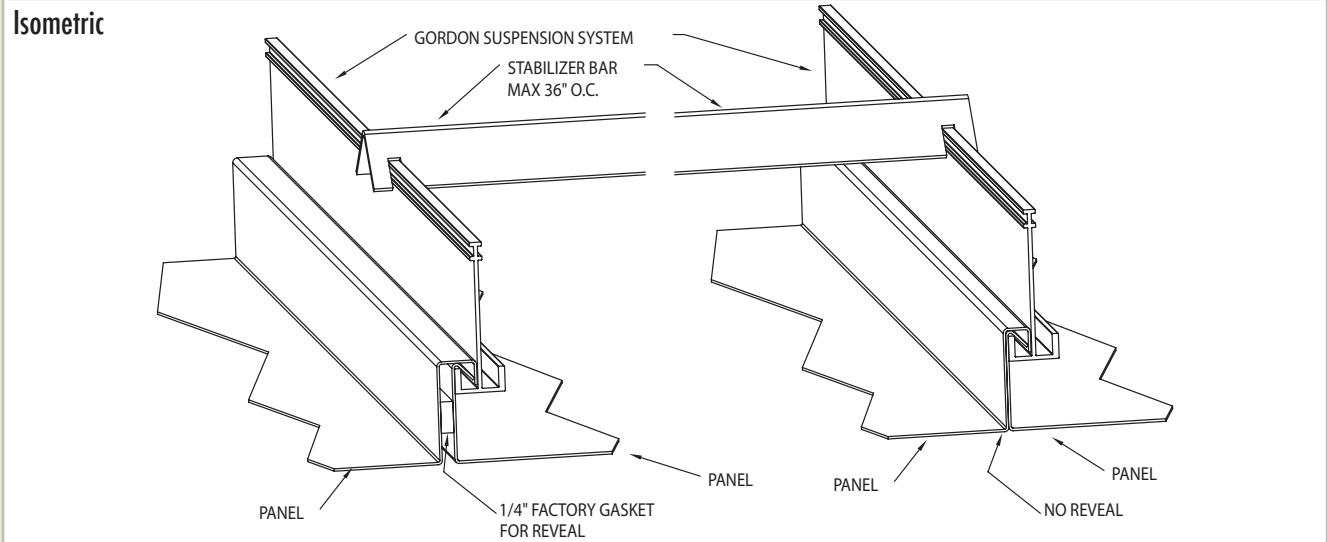

GORDON[®]
INCORPORATED

5023 HAZEL JONES ROAD, BOSSIER CITY, LA 71111
800.747.8954
800.877.8746 FAX
SALES@GORDON-INC.COM
GORDON-INC.COM
AN EMPLOYEE OWNED COMPANY

1 LEED[®] is a registered trademark of U.S. Green Building Council
2 FlexHead is a registered trademark of FlexHead Industries.

5023 HAZEL JONES ROAD, BOSSIER CITY, LA 71111



HK010 02.18