

FINAL FORMS I

UNIQUE TRIMS AND SHAPES IN PREFINISHED ALUMINUM

GORDON
INCORPORATED

[BUY ONLINE](#)

Aluminum Extrusions are 6063-T52 per ASTM B 221 and ASTM B 221 Metric. The finish is clear anodized 200-R1, which is corrosion resistant. Clear Anodized is a suitable finish for bonding with drywall compound. Clear Anodized can be installed as the final finish or can be used as a primer for field painting.

SERIES 940 SPECIAL SHAPES

PART NUMBER	
941-278-58	
PROJECTION EDGE TRIM used to step drywall. Also see 934.	

PART NUMBER	
942-HT-12	
942-HC	
LARGE HANGING TRACK AND HANGER. Also see 926 and 907.	

PART NUMBER	
943-3X-625	
3 STEP INSIDE CORNER TRIM used to accent corner conditions. Also see 902.	

PART NUMBER	A	B
944-3X-3350	3/8"	1/2"
944-3X-5858	5/8"	5/8"
3 STEP TRIM for use with multiple layers GPDW applications. Used to transition with varying wall thickness. Also see 924.		

PART NUMBER	
941-278-58	
PROJECTION EDGE TRIM used to step drywall. Also see 934.	

PART NUMBER	
942-HT-12	
942-HC	
LARGE HANGING TRACK AND HANGER. Also see 926 and 907.	

PART NUMBER	
943-3X-625	
3 STEP INSIDE CORNER TRIM used to accent corner conditions. Also see 902.	

PART NUMBER	A	B
944-3X-3350	3/8"	1/2"
944-3X-5858	5/8"	5/8"
3 STEP TRIM for use with multiple layers GPDW applications. Used to transition with varying wall thickness. Also see 924.		

FINAL FORMS I

SERIES 940



PART NUMBER	A
945-2X-14	1/4"
945-2X-12	1/2"
945-2X-58	5/8"
945-2X-100	1"
945-2X-200	2"

2 STEP OUTSIDE CORNER.
Also see 925 and 902.

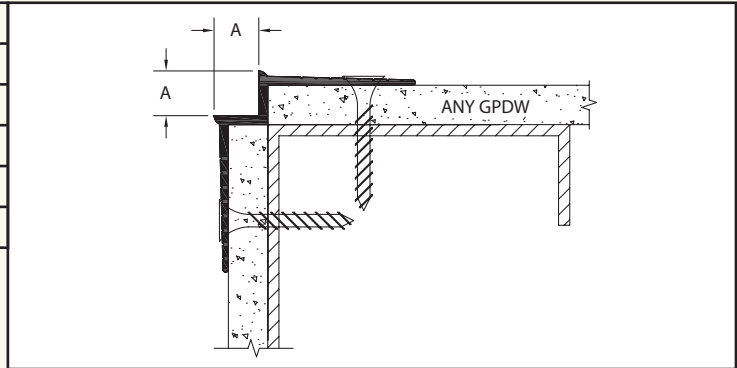

PART NUMBER
946-JT-45

J EDGE TRIM for double rock or wall board termination.
Also see 916 and 921.

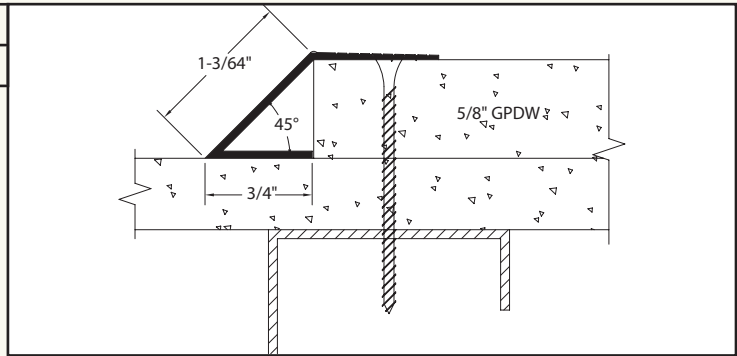

PART NUMBER
947-CM-25

PROJECTION MOLDING can be used directly on drywall to create a line or shape.
Also see 934.

