

# FINAL FORMS II

UNIQUE TRIMS AND SHAPES IN PREFINISHED ALUMINUM

**GORDON**  
INCORPORATED

BUY ONLINE ▶

## X CORNER TRIMS

CORNER TRIMS are available in clear satin anodized or painted finishes.

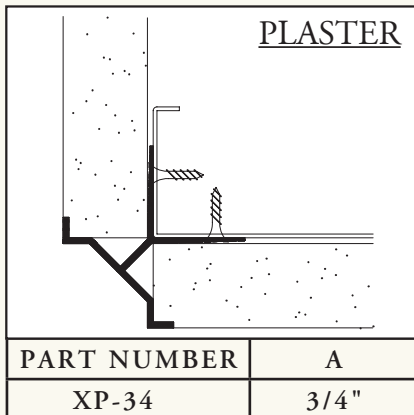
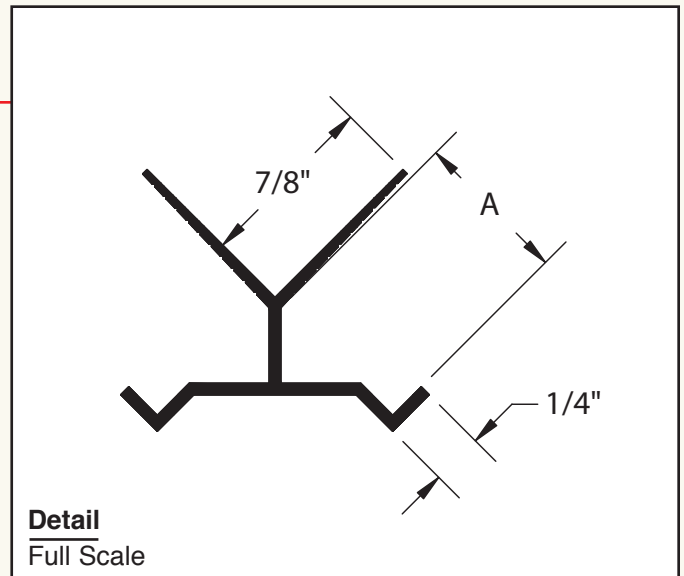

EDGE TRIM provides protective edge. Normally used at the edges of corners or soffits. Functions as an outside corner screed when used with plaster.

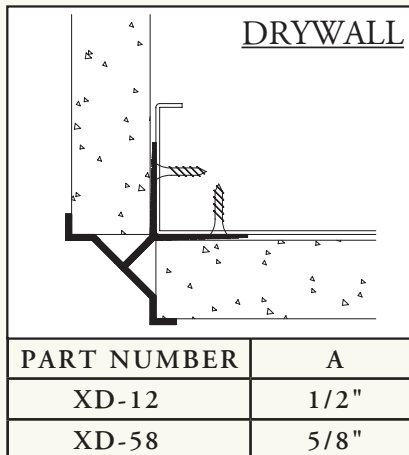

EDGE TRIM can be used as a trim around vertical and horizontal drywall corners.

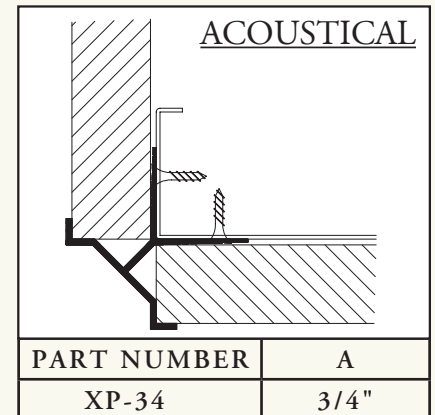

EDGE TRIM can be used as a trim around vertical and horizontal corners.

# FINAL FORMS II CORNER TRIMS



PART NUMBER
XS-1010

CORNER TRIM protects synthetic corner without a reveal.

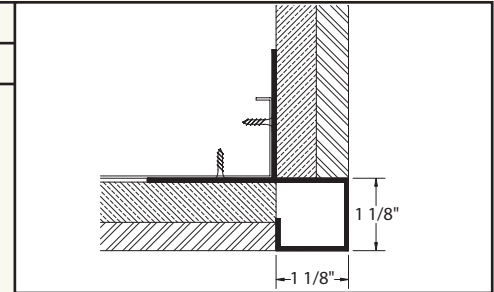

PART NUMBER	A	B
XHX-3838	3/8"	3/16"
XDX-5858	5/8"	1/4"
XPX-3434	3/4"	1/4"

EDGE TRIM provides protective edge and develops a reveal. Normally used at the edges of corners of soffits. Functions as an outside corner screed when used with plaster.

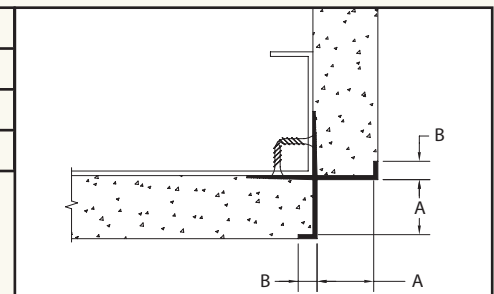

PART NUMBER
XPR-3434SP

CORNER TRIM provides protective curve corner. Normally used at the edge of soffits or corners. Functions as an outside corner screed when used with plaster.

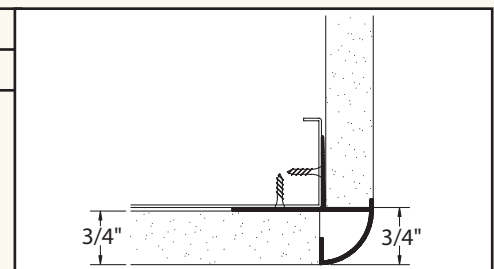

PART NUMBER
XPR-3434-SPS

CORNER TRIM provides protection for curved corners.

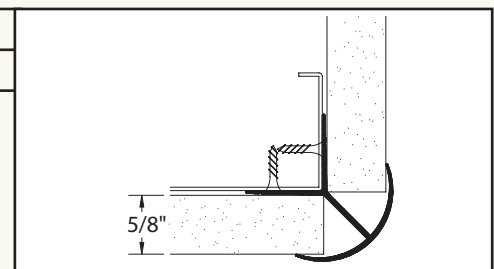

PART NUMBER	A
XPP-34	3/4"
XPP-150	1-1/2"
XPP-175	1-3/4"

CORNER ACCENT protects plaster corner with a minimal exposed metal surface.

