

# FINAL FORMS I

## UNIQUE TRIMS AND SHAPES IN PREFINISHED ALUMINUM

**GORDON**  
INCORPORATED

BUY ONLINE ▶

Aluminum Extrusions are 6063-T52 per ASTM B 221 and ASTM B 221 Metric. The finish is clear anodized 200-R1, which is corrosion resistant. Clear Anodized is a suitable finish for bonding with drywall compound. Clear Anodized can be installed as the final finish or can be used as a primer for field painting.

## SERIES 960 SPECIAL SHAPES

PART NUMBER	
961-HT-12	

HANGING TRACK transition at the ceiling. Also see 907.

PART NUMBER	
962-EC-200	

EDGE TRIM step transition from drywall to acoustical ceiling.

PART NUMBER	A	B	PART NUMBER	A	B
963-034-034	3/4"	3/4"	963-300-058	3"	5/8"
963-100-012	1"	1/2"	963-300-100	3"	1"
963-100-100	1"	1"	963-358-250	3-5/8"	2-1/2"
963-200-114	2"	1-1/4"	963-400-058	4"	5/8"
963-200-300	2"	3"	963-400-1316*	4"	13/16"
963-212-058	2-1/2"	5/8"	963-400-10516*	4"	1-5/16"
			963-600-034	6"	3/4"

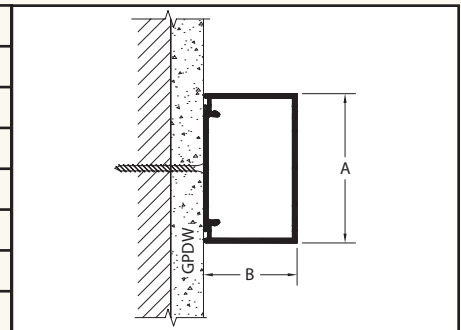

SNAP-ON DECORATIVE TRIM Matching end caps are available.

\*Appearance of part is different than what is shown.

PART NUMBER	
964-DM-1500	

DECORATIVE MOLDING for horizontal and vertical applications.

# FINAL FORMS I

## SERIES 960



PART NUMBER

965-2125R

EDGE TRIM for 2 layers of 5/8" drywall.

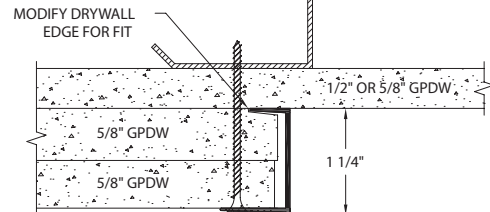

PART NUMBER

966-FT-12

CORNER FABRIC/VINYL TRIM accepts and protects the wall coverings edge to provide crisp corners. Also see 927.

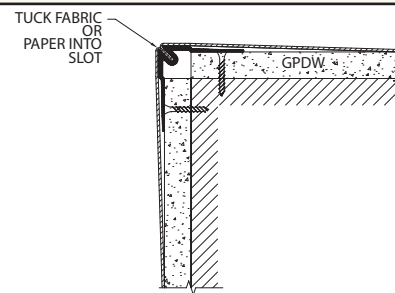

PART NUMBER

967-CT-58

CEILING TRIM transitions acoustical ceiling to drywall vaults or bulkheads.

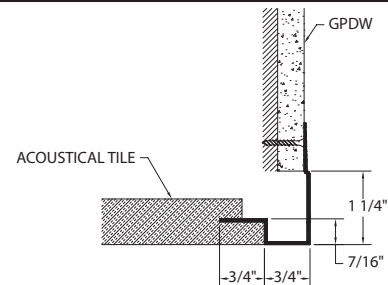

PART NUMBER

968-150-150

SNAP-ON DECORATIVE TRIM Matching end caps are available.

